

**TOP FLOOR**  
scale- 1:100

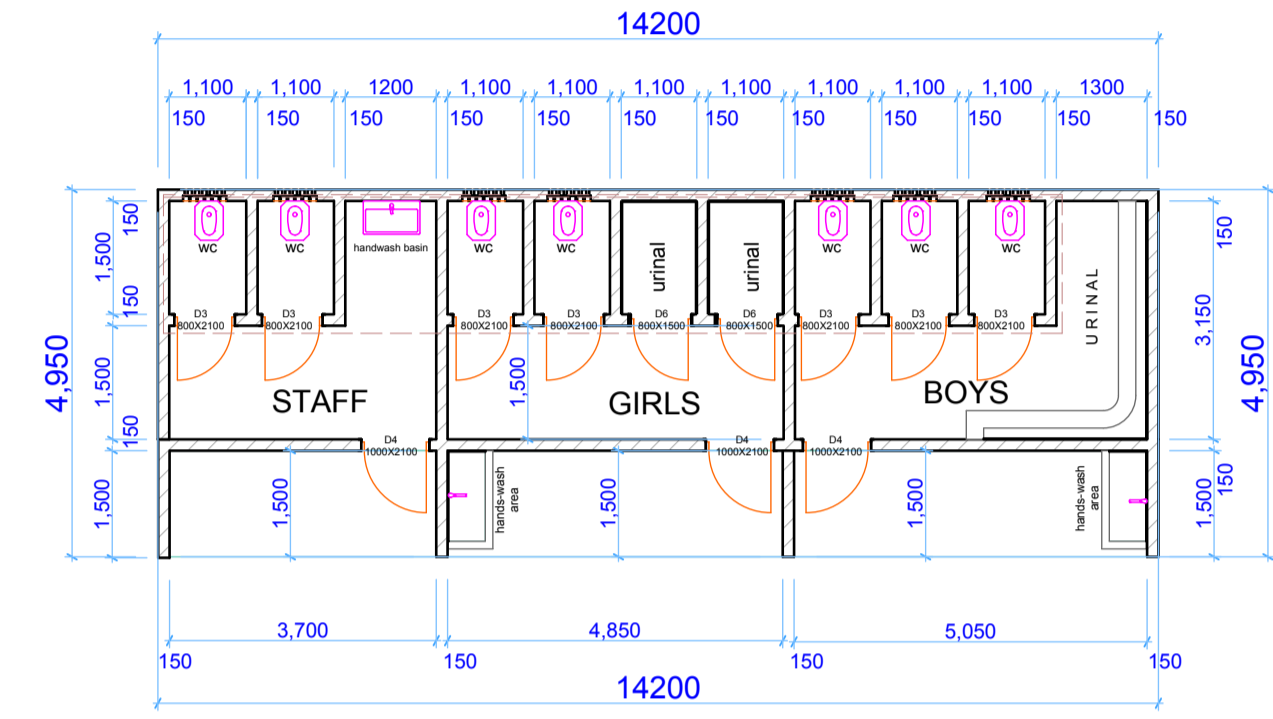

**PLAN (toilets)**  
scale- 1:100

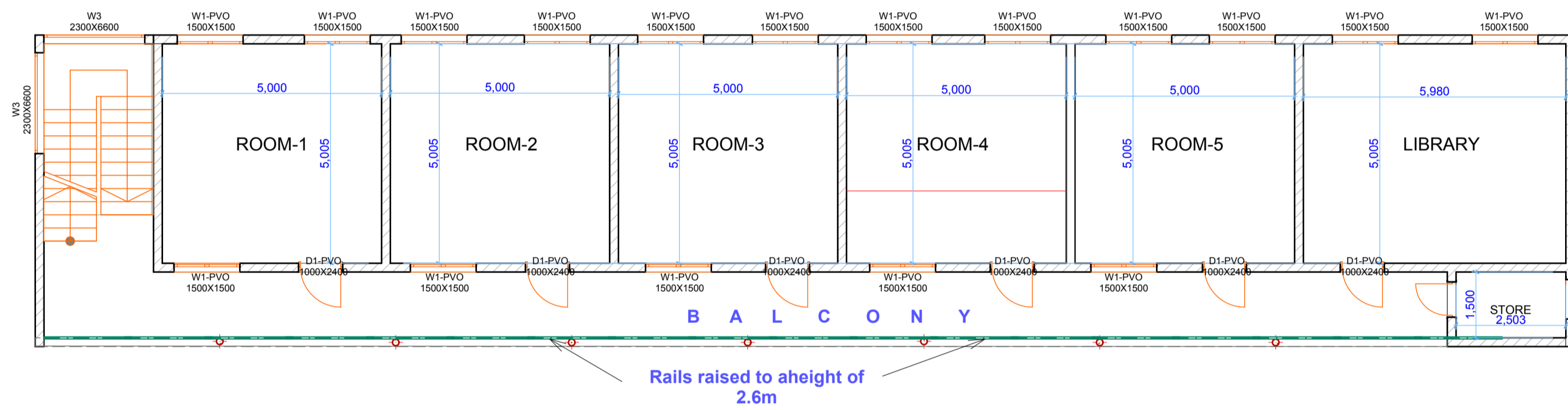

**MIDDLE FLOOR**  
scale- 1:100

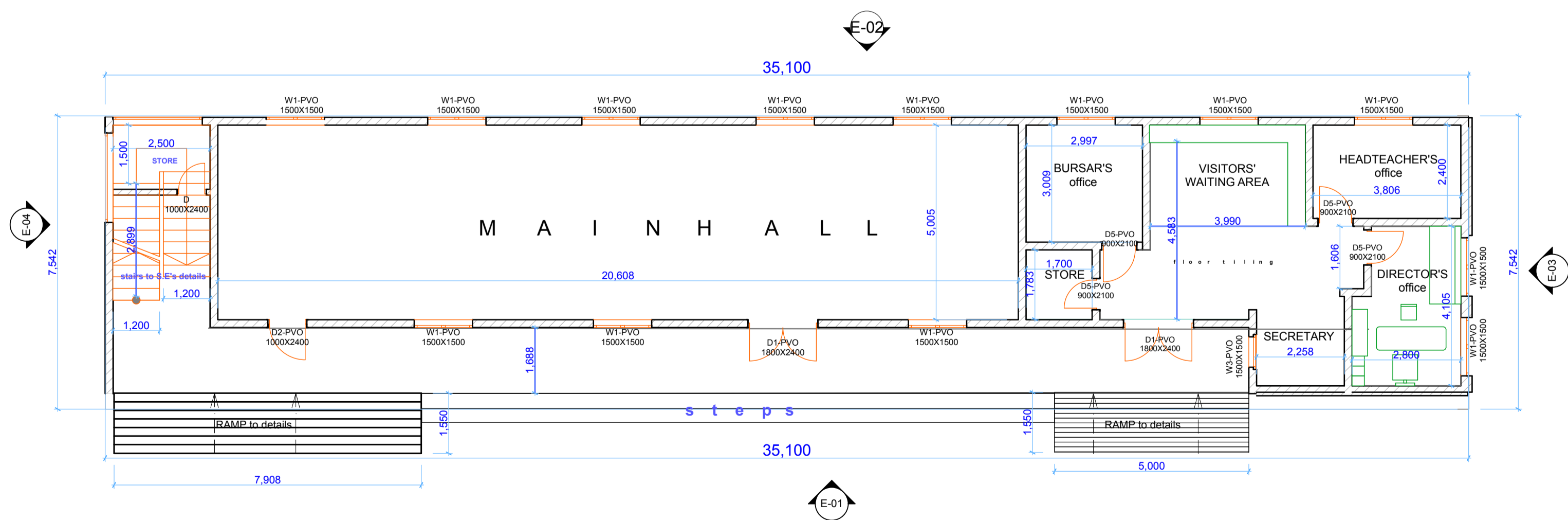

**GROUND FLOOR PLAN**  
scale- 1:100

**NB**

WC- water closet.

S.E- structural engineer.

PVO- permanent vent opening.

W- Window.

D- Door

**NOTES:**

- All work to be carried out in accordance with Local Authority regulations
- All figured dimensions to be taken in preference to scaled dimensions
- All walls below 200 mm to be reinforced with hoop iron at every alternative course
- Provide damp proof course (D.P.C.) under all walls
- P.V.O indicates permanent ventilations , MH- denotes manhole ,and WC- denotes waterclosets
- All drainage passing under building and drive area to be of pvc pipe and encased in concrete
- All inspection chambers in drive area to have heavy duty covers
- Check all dimensions on site
- All sanitary work to be in accordance with MoH rules and regulations
- 500g polythene sheeting & anti-termite treatment to be provided under ground floor concrete slab
- All reinforced concrete work is to be in accordance with structural engineer's details
- All internal plaster to be lime, two coats steel float finished
- All windows to have burglar proofing to detail
- All measurements in mm

**REVISIONS**

NO	DATE	REMARKS

**PROJECT:**  
PROPOSED PRIMARY SCHOOL  
( CIRCLE OF PEACE PRI SCH)  
on plot 21 mobutu road- makindye  
MAKINDYE -DIVISION- kanisa zone  
KAMPALA

**CLIENT:**  
BBAALE NAMAZZI MARYLOVE  
tel: 0792169571 / 0772418685

client's signature:

**CONSULTANT**

**TITLE:** plans , elevations

**DRAWN BY:** Hassan . K  
tel: 0700134273 / 0700039151

**CHECKED BY:**

**SCALE:** As shown

**DATE:** FEB - 2014

**SHEET NO:**  
**01**

**JOB NO:**